

- Specifically designed to dispense thicker, stringy materials with ease
- Features a disposable fluid path that carries materials from the material reservoir to the dispense tip, preventing contamination and air entrapment
- Stroke adjustment for precise, micrometer control over dispensing volumes
- Valve design allows for easy product changeover with minimal cleanup
- Fluid never comes into direct contact with the valve, reducing valve maintenance and extending the life of the valve
- Over-pinch adjustment prevents damage to the tube, extending its life, and cutting down on necessary replacement
- Adjustable suck-back control eliminates drooling and filming over of the nozzle for a clean, drip-free dispense when dispensing thin or stringy materials
- Shot-to-shot consistency when used with the DVC-345 valve controller
- Compatible with most standard fluid packages and delivery systems
- Lightweight, easy-to-handle and mount in automated or bench-top systems

Model 826

Disposable Fluid Path Valve Dispensing Systems

The Model 826 is a pneumatically operated, normally closed pinch valve. This dispense valve dispenses a wide variety of materials, and is specifically designed to dispense thicker, stringy materials with ease. The valve is highly precise and obtains its precision from lockable controls that facilitate the adjustment of three critical parameters: the flow rate through the valve, the amount of tube closure, and suck-back.

The valve's suck-back feature allows for the clean shutoff of stringy and tacky materials and prevents the formation of a droplet at the end of the dispense nozzle. It also minimizes the filming over of materials that tend to dry out at the end of the nozzle.

The valve also features a disposable fluid path which carries materials from the material reservoir to the dispense tip. Fluids are sealed within the fluid path, preventing contact with the valve's inner components and ensuring a contaminate-free dispensing process. The fluid path is easy to replace and requires minimum clean-up, allowing for rapid material changeover. This valve can be supplied with fluid paths of varying materials and sizes for optimum material compatibility.

The dispensing valve can be integrated into an automated dispensing system or can be paired with the Dymax DVC-345 Digital Valve Controller and a material reservoir to create a bench-top dispensing system.



Specifications

Specifications	
Valve Type	Pinch Valve with Disposable Fluid Path
Construction Materials	Anodized Aluminum
Operating Air Pressure	60-90 psi [4.1 - 6.3 bar]
Activation	Valve controller or 3-way solenoid valve
Maximum Inlet Fluid Pressure	Tubing Dependent; 100 psi [6.9 bar] Typical
Maximum Operating Temperature	150°F [65°C]
Maximum Tubing Size	0.25" [0.63 cm] OD
Dimensions (W x H x D)	1.13" x 2.5" x 2.66" [2.87 cm x 6.35 cm x 6.75 cm]
Weight	11 oz [312 g]
Unit Warranty	1 year from purchase date

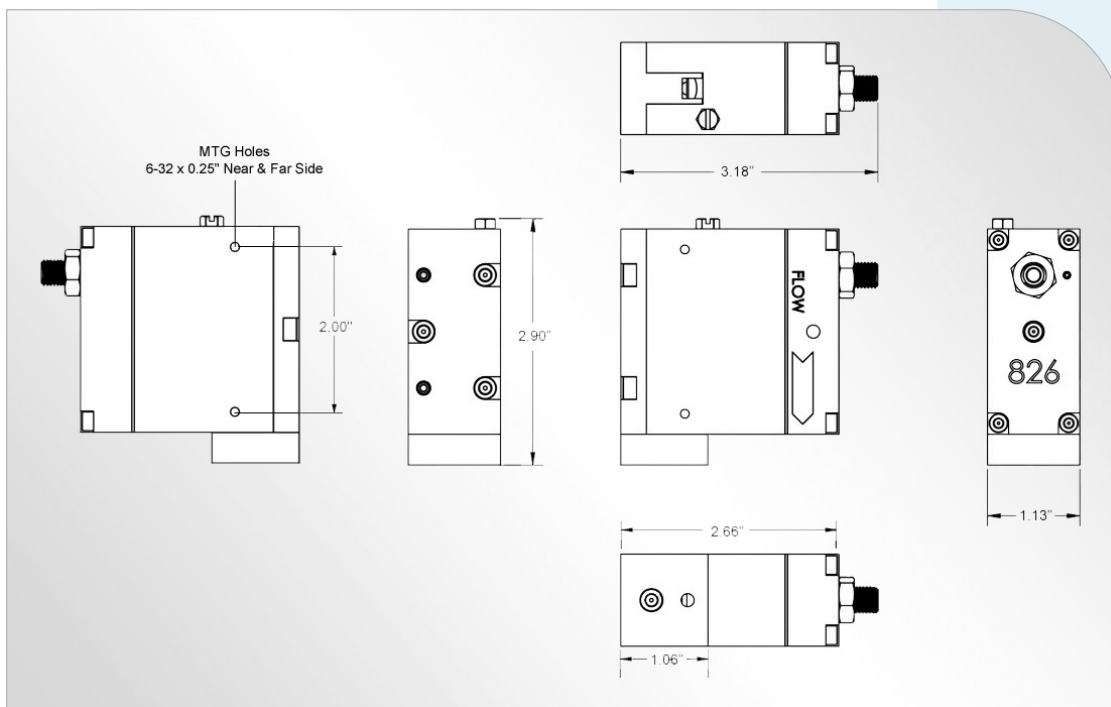
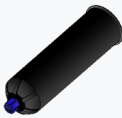

Figure 1. Model 826 Dimensions



Available System Packages

Systems Include:

- Model 826 Disposable Fluid Path Valve
- Selected Reservoir for Fluid Package Used
- DVC-345 Digital Valve Controller
- Air Filter/Regulator - 0-100 psi (0-6.9 bar)
- Controller Air Line Kit
- Fluid Line Kit - 6 ft of Black 1/4" (6.3 mm) OD tubing and 3/8" - 1/4" (9.5 mm - 6.3 mm) reducer and two 3/8" - 1/4" (9.5 mm - 6.3 mm) stem fitting inserts
- Valve Stand and Mounting Assembly
- Reservoir Air Line Kit
- Fluid Line Kit - 6 ft of black 3/8" (9.5 mm) OD tubing
- Air Precision Regulator - Includes three pressure gauges:
 - 0-30 psi (0-2 bar) for very low- to medium-viscosity materials
 - 0-60 psi (0-4.1 bar) for medium-viscosity materials
 - 0-100 psi (0-6.9 bar) for high-viscosity materials

System Part Numbers Based on Fluid Package Used					
Valve Only	Cartridge Drop-In			Large Bottle Drop-In	Pail Drop-In
	6 oz [160 mL]	12 oz [300 mL]	20 oz [550 mL]	Up to 1 Gallon	Up to 15 Liters Straight or Taper
					
T17586	T17805	T17806	T17807	T17808	T17809



6 oz (160 mL)



12 oz (300 mL)



20 oz (550 mL)

Cartridge Drop-In Reservoirs



Bottle Drop-In Reservoir



Pail Drop-In Reservoir

Spare Parts & Accessories

T11146	DVC-345 Digital Valve Controller
T15494	Black Polyethylene Tubing, 0.25" [0.63 cm] OD
T16307	Filter Regulator
T16629	High Precision Regulator
T15279	Lab Stand - 24" [60.96 cm]
T15449	Lab Stand - 8" [20.32 cm] with Mounting Rods
T15736	Black Male Luer Barb



www.dymax.com

Americas

USA | +1.860.482.1010 | info@dymax.com

Europe

Germany | +49 611.962.7900 | info_de@dymax.com
Ireland | +353 21.237.3016 | info_ie@dymax.com

Asia

Singapore | +65.67522887 | info_ap@dymax.com
Shanghai | +86.21.37285759 | dymaxasia@dymax.com
Shenzhen | +86.755.83485759 | dymaxasia@dymax.com
Hong Kong | +852.2460.7038 | dymaxasia@dymax.com
Korea | +82.31.608.3434 | info_kr@dymax.com